

### IRISH WATER WATERMAIN DETAILS

Details Required	Drawing No.	Drawing Title
Y	STD-W-01	Water service connection responsibility
Y	STD-W-02	Typical layout for water mains within developments
Y	STD-W-03	Customer connection & boundary box
Y	STD-W-04	General pipe connections (sheet 1 of 7)
Y	STD-W-05	General pipe connections (sheet 2 of 7)
Y	STD-W-06	General pipe connections (sheet 3 of 7)
Y	STD-W-07	General pipe connections (sheet 4 of 7)
Y	STD-W-08	General pipe connections (sheet 5 of 7)
Y	STD-W-09	General pipe connections (sheet 6 of 7)
Y	STD-W-10	General pipe connections (sheet 7 of 7)
Y	STD-W-11	Typical service layout indicating separation distances
Y	STD-W-12	Restrictions on water infrastructure works adjacent to existing trees
Y	STD-W-12A	Restrictions on new trees / shrubs planting adjacent to watermains
Y	STD-W-13	Trench backfill & bedding
N	STD-W-14	Sluice valve for ductile iron (D.I.) pipe (<350mm dia.) (sheet 1 of 2)
Y	STD-W-15	Sluice valve for polyethylene (P.E.) pipe (<350mm dia.) (sheet 2 of 2)
N	STD-W-16	On-line hydrant for ductile iron (D.I.) pipe (sheet 1 of 4)
N	STD-W-17	Off-line hydrant for ductile iron (D.I.) pipe (sheet 2 of 4)
N	STD-W-18	On-line hydrant for polyethylene (P.E.) pipe (sheet 3 of 4)
Y	STD-W-19	Off-line hydrant for polyethylene (P.E.) pipe (sheet 4 of 4)
N	STD-W-20	On-line air valve for ductile iron (D.I.) pipe (sheet 1 of 4)
N	STD-W-21	Off-line air valve for ductile iron (D.I.) pipe (sheet 2 of 4)
N	STD-W-22	On-line air valve for polyethylene (P.E.) pipe (sheet 3 of 4)
N	STD-W-23	Off-line air valve for polyethylene (P.E.) pipe (sheet 4 of 4)
N	STD-W-24	Pressure reducing / sustaining valve (P.R.V. / P.S.V.) chamber
N	STD-W-25	Booster pump station arrangement
N	STD-W-26	Non Mech. Meter chamber (40 - 250mm dia.)
N	STD-W-26A	Mech. Meter chamber (40 - 250mm dia.)
Y	STD-W-27	Marker posts / plates
Y	STD-W-28	Water main thrust & support blocks
N	STD-W-29	Duct chamber
Y	STD-W-30	Scour chamber & head wall arrangements
Y	STD-W-30A	Washout hydrant
Y	STD-W-31	Typical ditch / stream crossing for water main
Y	STD-W-32	Typical bridge crossing for water main (sheet 1 of 2)
Y	STD-W-33	Typical bridge crossing for water main (sheet 2 of 2)
N	STD-W-34	Security gate & fencing
N	STD-W-35	Pipe repair to existing mains
N	STD-W-36	Telemetry and wet kiosk
N	STD-W-37	Lamp bollard & lamp standard

**LEGEND:**

EXISTING 33" WATERMAIN (LAYOUT BASED ON SURVEY BY COASWAY SURVEYS DRAWINGS NO. 1889-001 F TO H, SURVEY DATED 16/10/2019)

EXISTING 33" WATERMAIN (RECORD DRAWINGS SHOWN THIS)

16.825 METRE WAYLEAVE CENTRED ON EXISTING 33" TRUNK WATERMAIN

**PROPRIETARY PRODUCT NAMES, MANUFACTURER'S NAMES, SUPPLIERS NAMES, NATIONAL STANDARDS**

WHERE A SPECIFICATION OR A DESCRIPTION OF A PRODUCT OR ELEMENT OF WORK INCLUDES A SPECIFIC MAKE OR SOURCE SUCH AS A PRODUCT NAME OR MANUFACTURER'S NAME OR A SUPPLIER'S NAME OR A NATIONAL STANDARD, THE SPECIFICATION OR DESCRIPTION SHALL BE DEEMED TO BE ACCOMPANIED BY THE WORDS "OR EQUIVALENT" NOTWITHSTANDING THAT THOSE EXACT WORDS MAY NOT IN FACT ACCOMPANY THE NAME OR STANDARD. THIS ALSO APPLIES WHERE THE NAME OR STANDARD IS ACCOMPANIED BY OTHER WORDS SUCH AS "OR EQUAL APPROVED" OR SUCH LIKE PHRASES.

**MATERIALS IN CONTACT WITH POTABLE WATER**

ALL MATERIALS, SUBSTANCES AND PRODUCTS IN CONTACT WITH POTABLE WATER SHALL COMPLY IN ALL RESPECTS WITH THE EUROPEAN COMMUNITIES (DRINKING WATER) (NO. 2) REGULATIONS, 2007 (S.I. NO. 278 OF 2007) AND SHALL BE INCLUDED IN THE LATEST "LIST OF APPROVED PRODUCTS AND PROCESSES" PUBLISHED BY THE DRINKING WATER INSPECTORATE FOR ENGLAND AND WALES. THE CONTRACTOR SHALL PRODUCE DOCUMENTARY EVIDENCE THAT THE SUBSTANCE OR PRODUCT HAS BEEN SPECIFICALLY APPROVED UNDER THE DWI SYSTEM, OR EQUIVALENT APPROVAL SYSTEM.

**LEGEND:**

PROPOSED Ø225mm HDPE PE-80 SDR11 TO ISEN 12201:PART 1 AND PART 2 AND ISEN 12201-3 WATERMAIN

PROPOSED Ø32mm HDPE PE-80 SDR11 TO ISEN 12201:PART 1 AND PART 2 AND ISEN 12201-3 WATERMAIN

PROPOSED Ø80mm HDPE PE-80 SDR11 TO ISEN 12201:PART 1 AND PART 2 AND ISEN 12201-3 WATERMAIN

PROPOSED Ø900mm HDPE PE-80 SDR11 TO ISEN 12201:PART 1 AND PART 2 AND ISEN 12201-3 WATERMAIN DIVERSION

PROPOSED BULK WATER METER

PROPOSED BOUNDARY BOX

PROPOSED HYDRANT

PROPOSED AIR VALVE

PROPOSED SCOUR VALVE

PROPOSED SLUICE VALVE

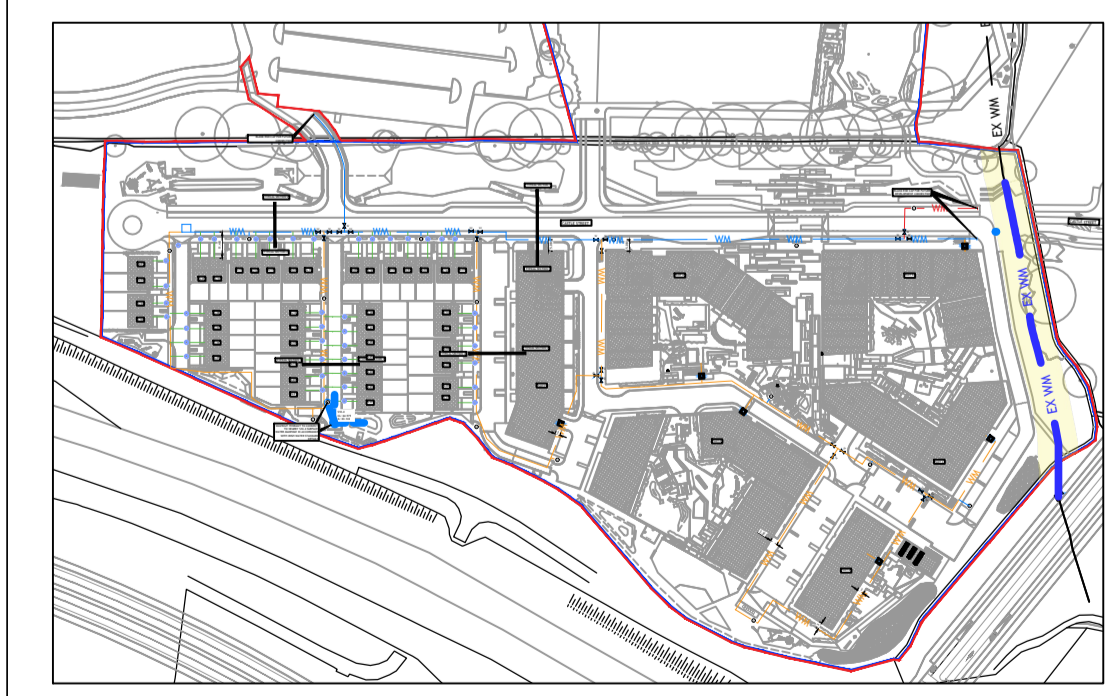

**SITE KEY PLAN**  
SCALE: NOT TO SCALE

© PUNCH Consulting Engineers

This drawing and any design hereon is the copyright of the Consultants and must not be reproduced without their written consent. All drawings remain the property of the Consultants. Figured dimension only to be taken from this drawing. Consultants to be informed immediately of any discrepancies before work proceeds.

Date Drawn: JANUARY 2019  
Drawn By: IBS  
Date Issued: 2020-07-31  
Issued By: JB

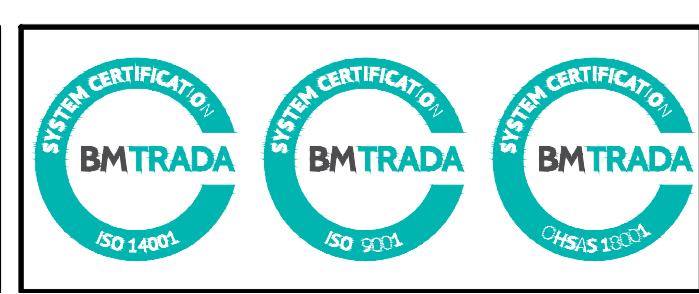

Rev	Amendment	By	Date
PLO	PLANNING ISSUE	JB	2022/03/28

Client:  
**1 CARRICKMINES LAND LTD.**

Job: PRIORSLAND CHERRYWOOD SHD  
Title: PROPOSED WATERMAIN LAYOUT - INTERIM PROPOSALS (SECTION 7.2.2)

**PUNCH** consulting engineers  
Dublin | Limerick | Cork | Galway | Glasgow  
Carnegie House, Library Road, Dun Laoghaire, Co. Dublin, A96 C7W7  
IRL: +353 1 271 2200 www.punchconsulting.com

Stage: PLANNING  
Scale @ A1: AS SHOWN  
Technician Check: IBS  
Engineer Check: MCD  
Approved:  
Rev: PLO

182-186-030

Ordnance Survey Ireland Licence No EN 0003720  
© Ordnance Survey Ireland/Government of Ireland